

FUJINON
FUJIFILM

Endoscopic CO₂ Regulator

GW-1

To achieve safer endoscopic examination and treatment



Example of System Configuration

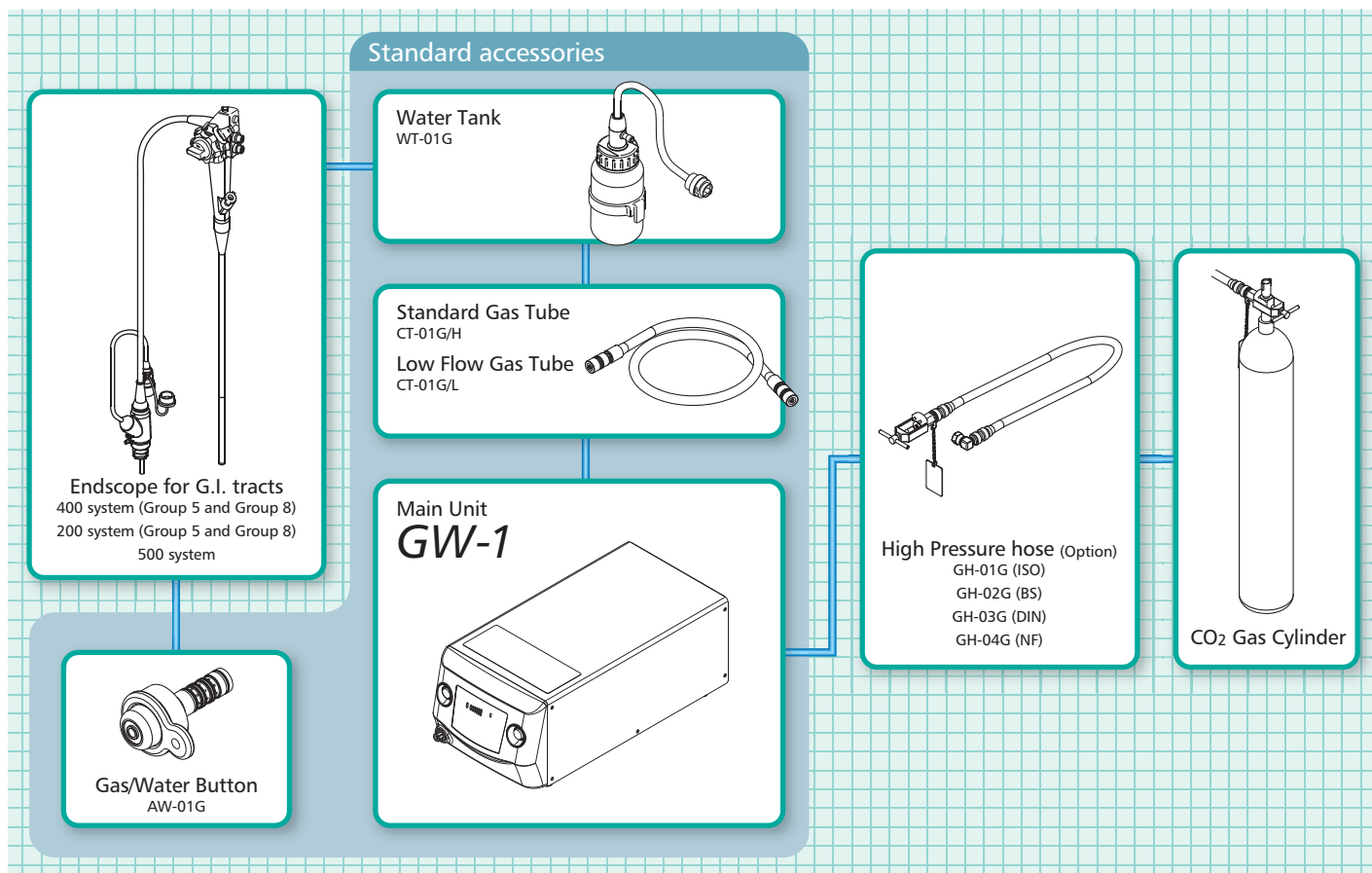

Endoscopic CO₂ Regulator GW-1 Specifications

Power	Voltage	230V AC 50Hz 0.20A
	Consumption	0.18A
Size	210 x 170 x 500mm	
Weight	10kg (Including standard accessories)	
Gas in use	Medical CO ₂ gas	
Gas indicator	Available	

FUJIFILM



Manufacturer
FUJIFILM Corporation
26-30, Nishiazabu 2-chome, Minato-ku, Tokyo 106-8620, Japan

FUJINON Inc.
10 High Point Drive Wayne, NJ. 07470, U.S.A.



Authorized Representative
FUJINON (Europe) GmbH
Halskestrasse 4,47877 Willich, Germany

FUJIFILM Regional Services (Singapore) Pte Ltd
114 New Industrial Road, Fujifilm Building, Singapore 536201

FUJIFILM Australia Pty Ltd
114 Old Pittwater Road, Brookvale, N.S.W. 2100, Australia

FUJIFILM Medical Systems (Shanghai) Co., Ltd.
No.68 Yin Cheng Zhong Road, Pudong New Area, Shanghai, P.R.China
ONE LUJIAZUI 27F-28F

CONTACT URL:<http://www.fujifilm.com/products/medical/endoscopy/contact/>